

"FC 01" LIMIT SWITCH

Description: **LIMIT SWITCH**



Casing material:

plastic

Protection degree:

IP65, according to IEC 529/ EN 60529

Electrical connection:

one cable inlet for PG13.5 cable gland

Operating temperature:

-25°C to +70°C

Storage temperature:

-30°C to +80°C

Applicable standards:

IEC 947-5-1
EN 60947-5-1

Appliance class:

II

Mounting positions:

all position are authorised

Fixing method:

by No 2 M4 screws

Operation head:

plain plunger

Contact:

1NO+1NC Snap action

Approvals:

CE, cULus

technical drawing

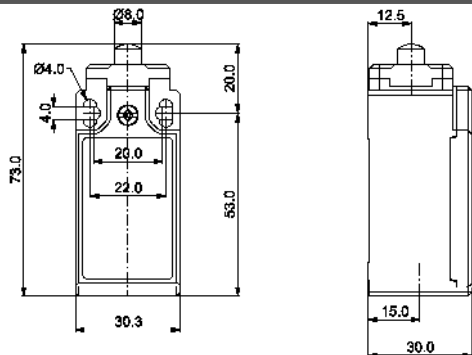

contact block

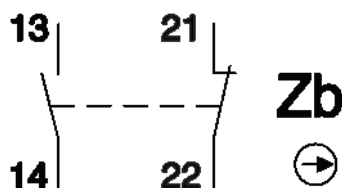

Model	Rated Voltage Range	Rated Current Range	Rated Voltage Range	Rated Current Range	Mechanical durability
	Va.c. 50/60 Hz	A (a.c.)	Vd.c.	A (d.c.)	Millions of operations
FC-001	24 - 400	10 - 4	24 - 250	6 - 0.4	15