

Reflectors for connectors 47.360

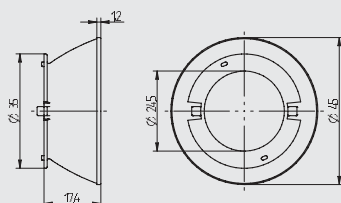

- Reflector can only be used when the connector is fixed with Push-to-Fix (P2F) **28.902**.-102.10 for blind holes or with lense head screws M3 and locking washer

CAD

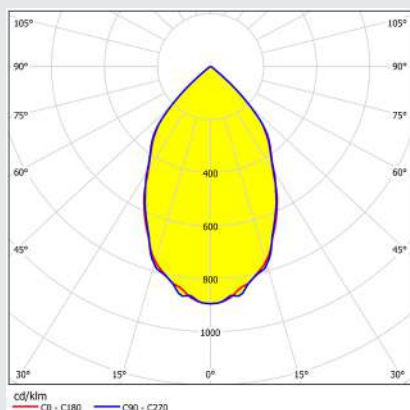

Connector 47.360.1010.50

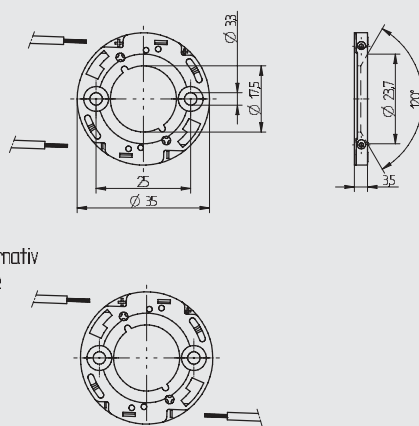

- With integrated CoB holder and interface for reflectors **47.935** and optics **35.201**
- Easy pre-assembly of LED
- Screw fixing: for screws M3 and locking washer
- Max. torque for screw fixing 0.5 Nm
- Strip length: 8+1 mm
- Polarity symbols of connector and LED must be observed in assembly
- Specification of LED manufacturer must be observed
- In a series connection of LED modules, the air gap and creepage distances has to be sized that each module covers the total voltage of the series connection

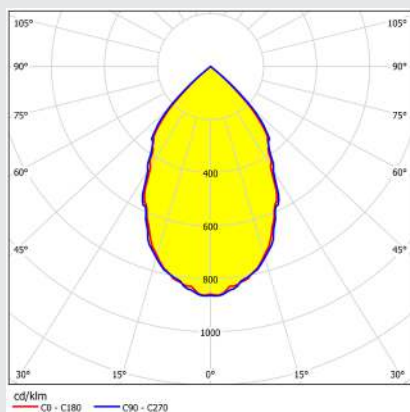

Citizen CLU028

FWHM: 63.6°

Efficiency: 91.9%

Connector **47.360.1020.50**

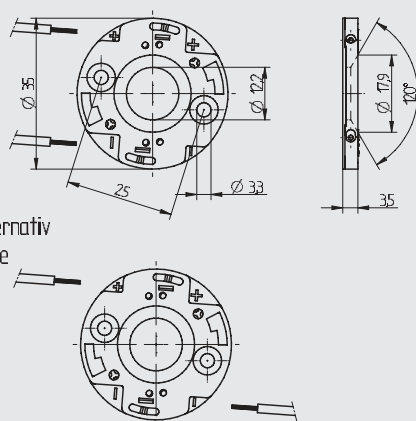

| pkg. | wt. | part no. |
|------|-------|-----------------------|
| 441 | 2.8 g | 47.360.1020.50 |

Connector for COB LEDs.

Screw fixing
Alternativ with Push-to-Fix (P2F) for blind holes
28.902.-102.10

Material: Housing: PPA
Cover: PBT

Contacts: CuSn
Rating: 3A / 60 V DC

- With integrated CoB holder and interface for reflectors **47.935** and optics **35.201**
- Easy pre-assembly of LED
- Screw fixing: for screws M3 and locking washer
- Max. torque for screw fixing 0.5 Nm
- Strip length: 8+1 mm
- Polarity symbols of connector and LED must be observed in assembly
- Specification of LED manufacturer must be observed
- In a series connection of LED modules, the air gap and creepage distances has to be sized that each module covers the total voltage of the series connection

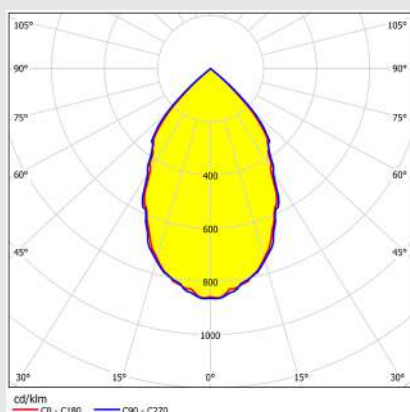

Cree CXA 1512

FWHM: 64.2°

Efficiency: 92.1%

Connector **47.360.1030.50**

| pkg. | wt. | part no. |
|------|-------|-----------------------|
| 441 | 2.4 g | 47.360.1030.50 |

Connector for COB LEDs.

Screw fixing

Alternativ with Push-to-Fix (P2F) for blind holes

28.902.-102.10

Material: Housing: PPA

Cover: PBT

Contacts: CuSn

Rating: 3A / 60 V DC

- With integrated CoB holder and interface for reflectors **47.935** and optics **35.201**
- Easy pre-assembly of LED
- Screw fixing: for screws M3 and locking washer
- Max. torque for screw fixing 0.5 Nm
- Strip length: 8+1 mm
- Polarity symbols of connector and LED must be observed in assembly
- Specification of LED manufacturer must be observed
- In a series connection of LED modules, the air gap and creepage distances has to be sized that each module covers the total voltage of the series connection

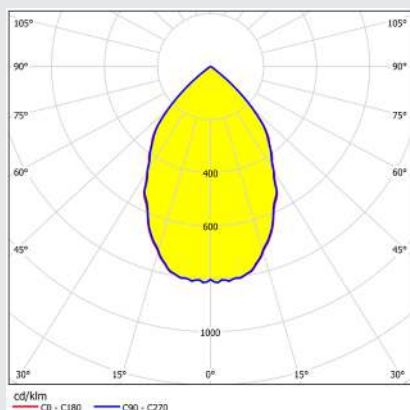
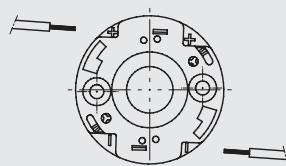
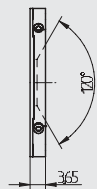
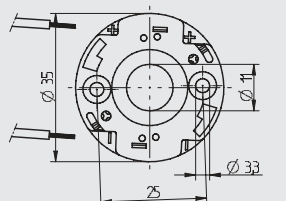
Verdrahtung alternativ
wiring alternative

Cree CXA 1820

FWHM: 69.2°

Efficiency: 91.6%

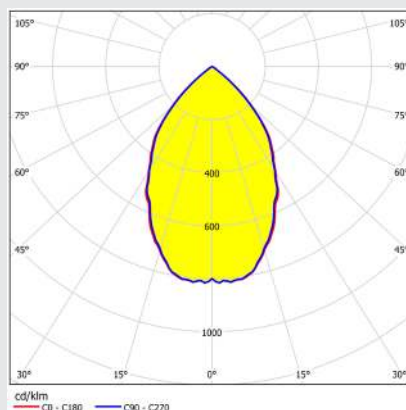
Connector **47.360.1040.50**

Cree CXA 1830

FWHM: 68.8°

Efficiency: 92.1%

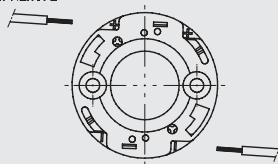
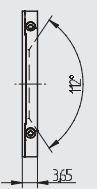
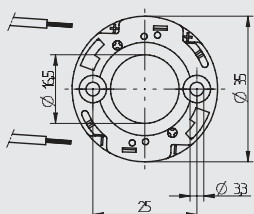
Connector **47.360.1040.50**Verdrahtung alternativ
wiring alternative

| pkg. | wt. | part no. |
|------|-------|-----------------------|
| 441 | 2.7 g | 47.360.1040.50 |

Connector for COB LEDs.

Screw fixing

Alternativ with Push-to-Fix (P2F) for blind holes

28.902.-102.10

Material: Housing: PPA

Cover: PBT

Contacts: CuSn

Rating: 3A / 60 V DC

- With integrated CoB holder and interface for reflectors **47.935** and optics **35.201**
- Easy pre-assembly of LED
- Screw fixing: for screws M3 and locking washer
- Max. torque for screw fixing 0.5 Nm
- Strip length: 8+1 mm
- Polarity symbols of connector and LED must be observed in assembly
- Specification of LED manufacturer must be observed
- In a series connection of LED modules, the air gap and creepage distances has to be sized that each module covers the total voltage of the series connection